

# 24/7 online access to benefits and service

Register today

Visit [DeltaDentalMO.com/Members/Register](http://DeltaDentalMO.com/Members/Register) to receive electronic delivery of your benefit information. Once registered, log in to your account online or with the Delta Dental Mobile App.



## You have access to important plan information

- Review and print your dental plan's coverage levels, deductibles, maximums, age limits and limitations
- Verify your eligibility
- Request or download a claim form
- Order or print an ID card
- View your Explanation of Benefits (EOB)
- Get answers to frequently asked questions



### Log in to view your benefits

Visit [www.DeltaDentalMO.com](http://www.DeltaDentalMO.com), and click on one of the **Member** or **Sign In** links. To register, follow the steps under **Member Sign In**.



### Find a Delta Dental participating dentist

Visit [www.DeltaDentalMO.com](http://www.DeltaDentalMO.com), and click on **Find a Provider** then on **Find a Dentist**.



### Call or email customer service

We are here to help every Monday through Friday from 7 am to 5 pm CT.

☎ **800-335-8266**

✉ **Service@DeltaDentalMO.com**

## Download Delta Dental Mobile App

Your dental health is important to Delta Dental – and to your overall health! We've designed our mobile app to make it easy for you to make the most of your dental benefits. Maximize your health, wherever you are!

- **Mobile ID card:** No need for a paper card. View and share your ID card from your phone.
- **Find a dentist:** Search and compare dental offices to find one that suits your needs.
- **Dental Care Cost Estimator:** Our easy to use tool provides estimated cost ranges on common dental care needs for dentists in your area.
- **Save your preferred dentist for quick access:** Save your favorite dentists using the Delta Dental Mobile App for quick access to contact information making it easy to schedule your routine cleaning.





# Member benefits go beyond your ID card

## Our suite of member tools gives you access to more.

As the nation's leading provider of dental insurance with the largest nationwide network, we are proud to call you a member.

We're also excited to offer you more of what you want from a dental benefits plan, including ways to securely access your information. Whether you're looking for plan information, updates on benefits or timely educational information, we have the online resources you need to get you there.



## Access your member account tools

Once you've registered for an online member account, you have access to important, real-time plan information including:

### Claim information

Review specific claims, reimbursements, payments and estimates. You can also print a copy of your Explanation of Benefits (EOB) and sign-up for paperless delivery of EOBs.

### ID cards

Request or print a copy of your ID card.

### Eligibility

Find current eligibility for you and your dependents.

### Up-to-date benefit information

Review your specific benefits, including your network program type.

## Signing up is easy.

Visit [DeltaDentalMO.com/Members/Register](https://www.DeltaDentalMO.com/Members/Register) and set-up your account for complete member access.

# More helpful resources for you

Find even more ways to get connected online to the information you want.



## Find a dentist

When you need to find a dentist, check our online directory. You can easily find the perfect dentist for you and your family based on specialty, plan and location.

## Health information, tips and resources

Our online resources offer you a variety of health topics, wellness tools and much more. There are many to choose from including:

### Mobile app

Maximize your health, wherever you are! Search for a dentist near you, view ID cards and more, right on your mobile device.

### Oral health risk assessment

Evaluate and improve your oral health with this simple tool.

### Grin! Magazine

Newsletter with information on wellness, benefits and tips for good oral health.

### Dental health email sign-up

eNewsletter with tips to improve oral health.

### Protect my smile

Provides articles and information on wellness, dental health and more.

### Social media

Follow us for tips and health information from industry experts.

### Cost estimator

A handy tool for estimated costs for common dental care needs.

### How to use your benefits guide

On our member page, find this step-by-step guide to get you started on the path to a healthier smile.

# Member portal instructions

To sign in to your account, go to [www.DeltaDentalMO.com](http://www.DeltaDentalMO.com)

1 Hover over **Sign In** in the top right corner

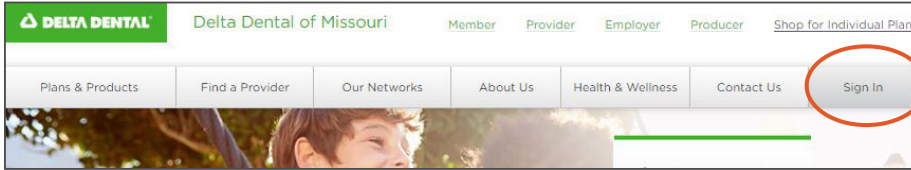

2 Click **Member**, then click **Employer Plan** (if you have benefits through your company) or **Individual & Family Plan** (if you enrolled in your own policy through Delta Dental)

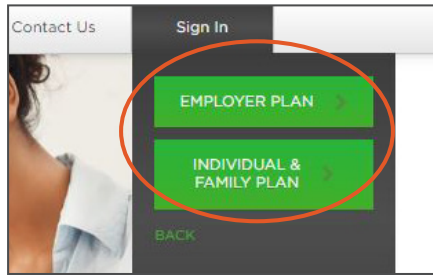
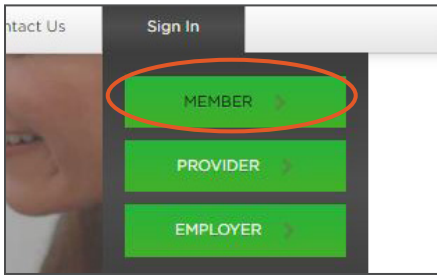

3 Choose **Dental Plan**

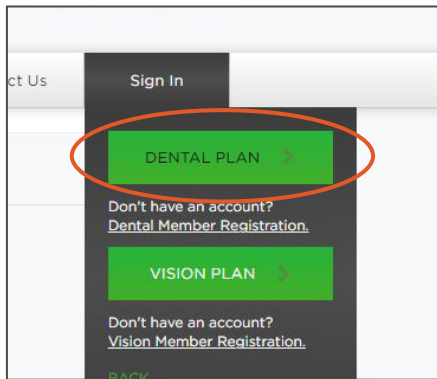

4 Enter your **username and password** and click **Log In**

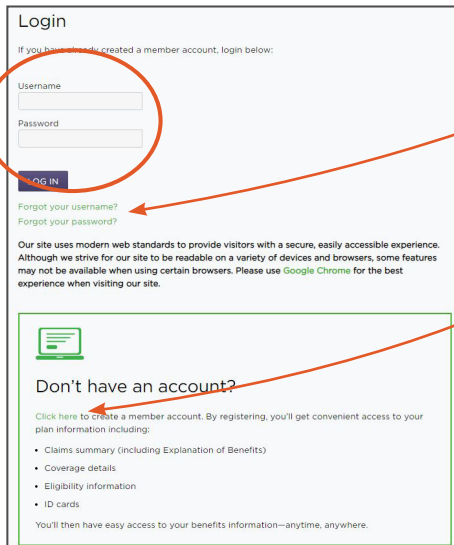

**Sign into your account for 24/7 access to important plan information:**

- Review and print coverage documents
- View claim summary/explanation of benefits (EOB)
- Download a claim form
- Order or print an ID card

To retrieve your username or password, click on [Forgot your username?](#) Or [Forgot your password?](#)

Don't have an account? Click [Dental Member Registration](#)

We are here to help!

Call or email customer service at **800-335-8266** or [service@DeltaDentalMO.com](mailto:service@DeltaDentalMO.com)